

SMD Molded Power Inductor

GCDA1265 Series



FEATURES

- Integrated Shielding Construction
- Alloy Material with Excellent withstanding Current Characteristics
- Featured with High Inductance and Low DCR Characteristics
- Variable Inductance Value (33uH ~ 100uH) with Wide Frequency Range
- Operating Range: -45°C~+125°C(Including Self- Temperature Rise)
- RoHS Compliant

PART NUMBER CONSTRUCTION

GCDA1265

Series

680

Inductance*

M

Tolerance①

T

Packing②

① Tolerance: M = 20% N = 30%

② Packing: B = Bulk T = Tape and Reel

*Refer to Electrical Specification table

ELECTRICAL SPECIFICATIONS

Part Number	Inductance(μH) ±20%	DCR(mΩ)		Irms (A)	Isat (A)
		Typical	Max		
GCDA1265-330M	33	50	60	5	8
GCDA1265-470M	47	72	85	4	7
GCDA1265-680M	68	103	120	3	6
GCDA1265-820M	82	142	160	3	6
GCDA1265-101M	100	155	180	2.5	4.5

PRODUCT DIMENSIONS

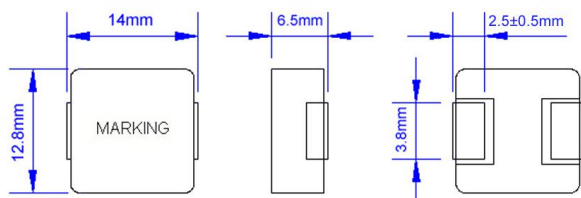

RECOMMENDED LANDING PATTERN

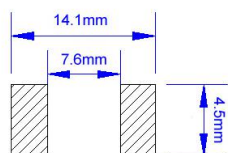

MATERIALS & STRUCTURE

Core: Alloy Powder

Wire: Copper

Terminal: Nickel Plating

Ink: Black

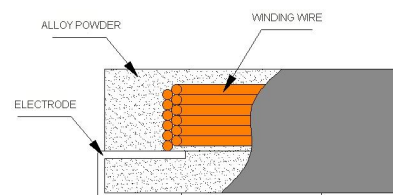

PACKING

500PCS/REEL